

1310nm 4mw DFB Coaxial Pigtailed Laser Diode with PMF

1310nm SM fiber coupled LD with Polarization Maintaining Fiber

WSLP-1310-004m-PM-DFB

Wavespectrum laser inc.

www.wavespectrum-laser.com

PARAMETER	SYMBOL	VALUE	UNIT
LD Reverse Voltage	V_r	2.0	V
PD Reverse Voltage	$V_{r(PD)}$	15	V
Operating Temperature	T_{op}	-10~+85	°C
Storage Temperature	T_{stg}	-40 ~ +85	°C
Lead soldering temperature (10 sec.)	T_{is}	260	°C

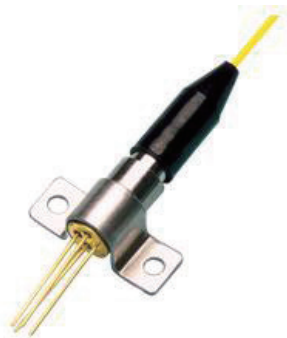
Features: <ul style="list-style-type: none"> ● 1310nm ● DFB Laser Diode ● Built-in Monitor ● With PM Fiber ● Isolation Optional ● Coaxial/Receptacle package 			
Applications: <ul style="list-style-type: none"> ● Test Equipments ● Optical Bidi Module and Optical Receiver ● Optical Transmitter of Analog Signal ● Optical Transmitter of Data Signal 			
Specifications	WSLP-1310-004m-PM-DFB		
	Min	Type	Max
Center Wavelength@25°C	1290nm	1310nm	1330nm
Laser Type	DFB		
Output Power	----	4mW	----
Fiber Core	PM Fiber		
Threshold Current (Typ.) I_{th}	----	12mA	----
Operating Current	----	66mA	----
Operating Voltage	----	1.4V	----
Spectral Width(nm@20dB)	----	0.23	----
SMRS	----	35dB	----
Rs(ohms)	----	12.98	----
Monitor Current	0.1mA	----	----
PD Capacitance	----	10pF	15pF
PD Dark Current	----	----	0.1uA
Slope	----	0.38W/A	----
Package Style	Pigtail/Receptacle		
Data Rate	----	2.0Gb/s	----
Fiber Connector	FC/SC/ST/LC/MU		

Modulation Frequency upto 2GHz

Coaxial Package View

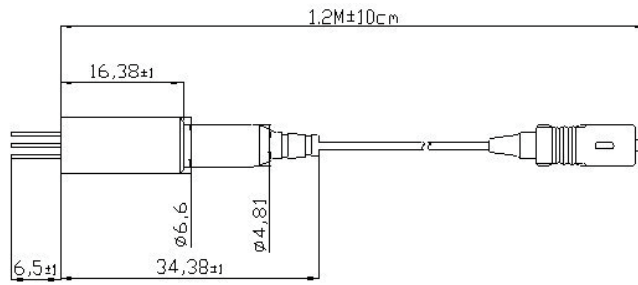

Bottom View

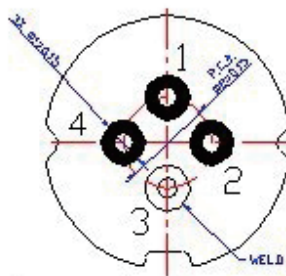

TYPE A
PIN ASSIGNMENT:

1	PD Cathode
2	PD Anode
3	LD Anode, GND
4	LD Cathode

**Electrically shorten LD module and store in non-extreme conditions.
Suggest using the constant current power supply.**

